

San Telequip (P) Ltd.,
 504,505 Deron Heights, Baner Road
 Pune 411 045, India
 Phone : +91-20-27293455, 9764027070, 8390069393
 email : info@santelequip.com



Connecting. Converting. Leading !

Industrial Grade Gigabit Ethernet-to-Fiber Media Converter, Model SC12FEISG S

Feature



- ✓ Adopts integrated module, ensure reliable data transmission
- ✓ Supports Full or half-duplex, auto negotiation
- ✓ Auto 10/100/1000Mbps
- ✓ Auto MDI/MDI-X
- ✓ Plug & play, easy to use
- ✓ Operating temperature -40deg C to 85deg C
- ✓ Input voltage 12/24/48VDC (10.8 to 52.8VDC), Reverse polarity protection

SC12FEISG S series are Gigabit Ethernet to fiber media converters. It provides 1* 10/100/1000Base-T Ethernet port and 1* 1000Base-X fiber port. It is used for data communication between Ethernet port & Fiber port. The operating temperature is -40 to 85 deg C, together with strong EMC performance, it guarantees device working stability in harsh environment. The device greatly extends network transmission distance.

Specification

Standards

IEEE802.3, IEEE802.3u, IEEE802.3z, IEEE802.3ab, IEEE802.3x

Interface

RJ45 ports : 1* 10/100/1000Base-T, Auto detection, Full/Half-duplex, Auto MDI/MDI-X

Fiber ports : 1* 1000Base-X SFP

	1000Base-X			
	Multi-mode	Single-mode		
Wavelength	1310	1310	1310	1550
Transmission distance	2	20	40	80
Transmit Power	-6 - -1	-9 to -3	-2 to -3	-2 to -3
Receive sensitivity dBm(s)	-21	-23	-23	-24
Light saturation dBm	0	-3	-3	-3
Optical loss dBm/km	0.5	0.5	0.3	0.25
RJ-45 port transmission rate	10/100/1000Mbps			

Fiber cable core diameter

Multi-mode : 50/125, 62.5/125

Single-mode : 8.3/125, 9/125, 10/125

LED indicators: PWR, FDX

Switching performance

Forwarding rate : 1,488,100pps

Transmission mode : Store-and-Forward

MAC address table : 16K

Buffer : 1Mb

Bandwidth : 12G

Max. frame length : 10KB

San Telequip (P) Ltd.,
504,505 Deron Heights, Baner Road
Pune 411 045, India
Phone : +91-20-27293455, 9764027070, 8390069393
email : info@santelequip.com



Connecting. Converting. Leading !

Power requirement

Input voltage : 12/24/48VDC (10.8 to 52.8VDC)
Power consumption : 100mA @ 24Vmax
Connector : Plugable 3-pin terminal block
Overload protection : Present
Reverse polarity protection : Present

Physical characteristics

Housing : IP40
Installation : DIN-Rail
Dimension : 100mm x 80mm x 35mm

Environmental limits

Operating temperature : -40deg C to 85deg C
Storage temperature : -40deg C to 85deg C
Relative humidity : 0 to 95% (non-condensing)

Industrial standards tested for

EMI: FCC Part 15 Subpart B classA, EN55022 class A
EMS
IEC(EN)61000-4-2(ESD)
IEC(EN)61000-4-3(RS)
IEC(EN)61000-4-4(EFT)
IEC(EN)61000-4-5(Surge)
IEC(EN)61000-4-6(CS)
IEC(EN)61000-4-8
IEC 60068-2-27(Shock)

Dimension

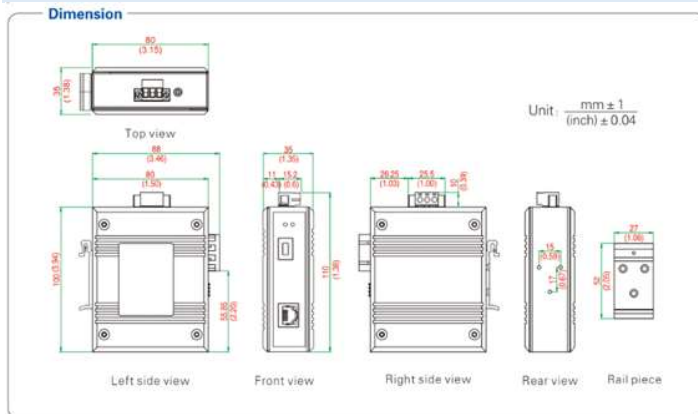

Ordering Code : SC12FEISG S

SC12FIES : Industrial Grade Media Converter
G : 10/100/1000 TX Port
S : 1000FX SFP Port